

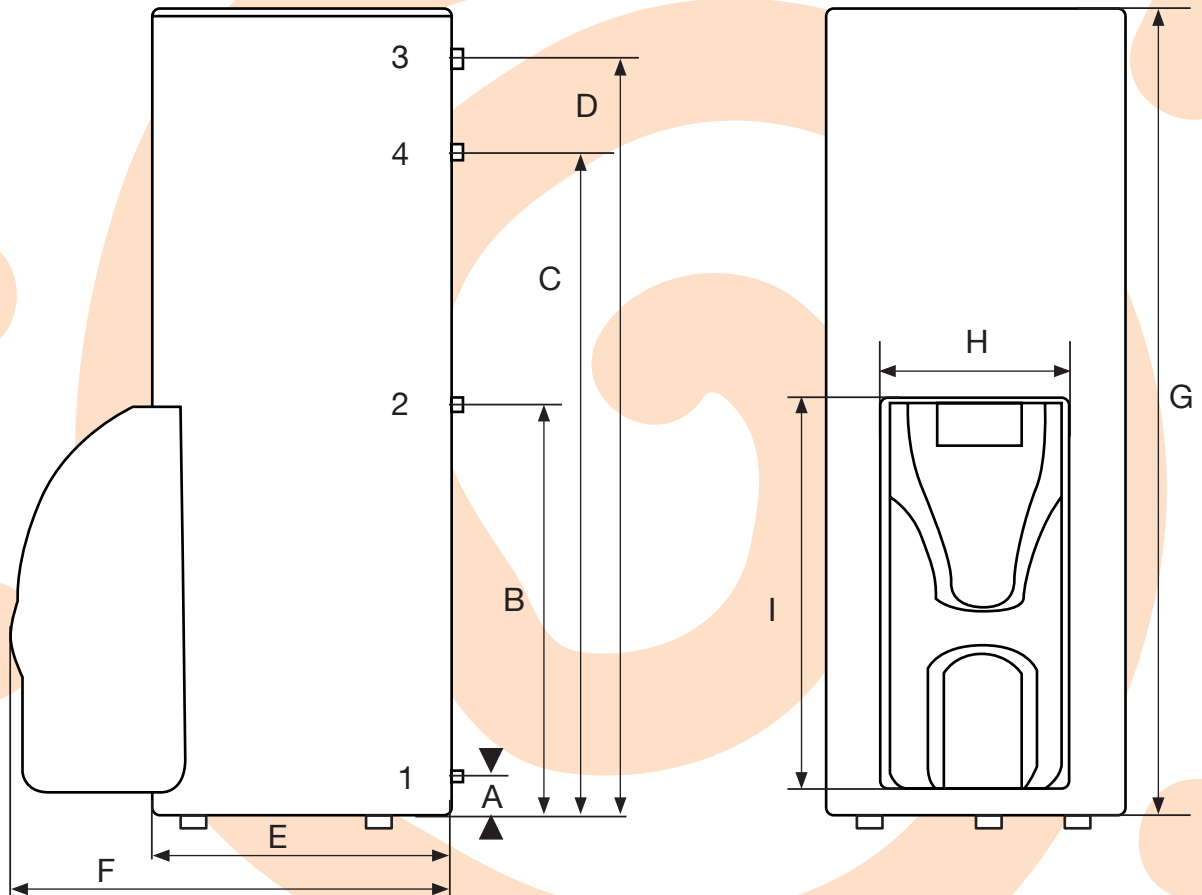

PRECHARGED SYSTEM
PST200v, PST250v

- 1 – Cold water inlet
- 2 – Recirculation
- 3 – Hot water outlet
- 4 – TPR Valve

Dimensions are subject to change without notice.

Model	A	B	C	D	E	F	G	H	I
	mm.								
PST200v	74	650	1326	1274	580	880	1350	370	765
PST250v / PST 250i	74	815	1326	1454	580	880	1530	370	765

PST 200v / PST 250v / PST 250i

Storage Water Heater

Dry weight	73 / 83 / 62	Kg
Volume	200 / 250 / 250	lts
Type of internal protection	Enamelled / Stainless steel	
Cathodic protection	Magnesium anode	
Hydraulic joints (Cold Hot TPR valve Recirculation)	3/4" Male 3/4" Male 1/2 Female 3/4" Female	Pol.
Maximum pressure	7	bar
Test pressure	10	bar
Maximum water temperature	80	°C
Water temperature	55	°C

Thermodynamic Solar Panel

Material	Solokote Anodized Aluminium	
Dimensions (L x A x e)	2000x800x20	mm.
Maximum working pressure	12	bar
Test pressure	15	bar
Maximum exposure temperature	120	°C
Minimum running temperature	-5	°C
Minimum exposure temperature	-40	°C

Thermodynamic Block

Width	310	mm.
Height	500	mm.
Depth	230	mm.
Weight	18,5	kg.
Absorbed power (Average/Max)	390 - 550	W
Thermal power (Average/Max)	1690 / 2510	W
Electrical support power	1500	W
Compressor Type	Rotational	-
Compressor Noise Level	39	dB.

Cooling Couplings

Cooling Fluid / Amount*	R134a / 1000*	- / gr.
Piping Material	Copper (DHP ISO1337)	-
Line of liquid	1/4"	pol.
Line of aspiration	3/8"	pol.

ELECTRIC BOARD

Power feed	230 monophase / 50	V / Hz.
Compressor fuse	7	A
General fuse (resistance and electronic circuit-breaker)	7	A